



NEW YORK ENDOVASCULAR SUMMIT



Exhibitor and Promotional Partnership Prospectus

October 6-8, 2022 • etc.venues • New York, New York

WELCOME

Thank you for your support and participation in the **2022 NY Endovascular Summit & Mount Sinai Endovascular Fellows Course**. The following will provide you with important information about this year's meeting and your participation as an exhibitor. If you have any questions or need further assistance, please do not hesitate to contact the NYEVS Exhibit Managers at Gaffney Events: Trinity Campbell, trinity@gaffneyevents.com, 425.354.8937 or Jennifer Berens, jennifer@gaffneyevents.com, 425.442.1314. We look forward to working with you and assisting to ensure a successful conference for your organization!

SYMPOSIUM LOCATION

etc.venues | 360 Madison Avenue (Corner of Madison & East 45th) | New York, NY 10017

HOTEL ACCOMMODATIONS

You are responsible for making your hotel room reservations for your company personnel. Please note that room reservations should be made in advance. Below are a few suggested hotels within walking distance of etc.venues. There are no group blocks reserved at these hotels:

The Gotham Hotel NYC
16 East 46th St.
New York NY 10022

(4 Star) Distance: 300 ft.
Phone: 212.490.8500
thegothamhotelny.com

Club Quarters Hotel, Times Square
40 W. 45th Street
New York, NY 10036

(4 Star) Distance: 0.2 mi.
Phone: 212.354.6400
clubquartershotels.com

The Intercontinental Barclay
111 East 48th St.
New York, NY 10017

(4 Star) Distance: 0.3 mi.
Phone: 212.755.5900
intercontinentalnybarclay.com

The Iroquois
49 West 44th St.
New York, NY 10036

(4 Star) Distance: 0.2 mi.
Phone: 212.453.4067
iroquoisny.com

The Royalton
44 West 44th St
New York, NY 10036

(4 Star) Distance: 0.2 mi.
Phone: 212.869.4400
royaltonhotel.com

Westin Grand Central
212 E 42nd St
New York, NY 10017

(4 Star) Distance: 0.6 mi.
Phone: 212.490.8900
marriott.com

EXHIBIT SPACE AND EQUIPMENT

Exhibits will be located in etc.venues, 4th Floor, Galleria. Registration, Fellows Course, Peripheral Arterial Disease Symposium, and the Faculty Lounge/Speaker Ready will be located on the 4th floor on Thursday, Friday and Saturday. Friday and Saturday Venous and Aortic Sessions and the Saturday, Nurse/Tech, Women and Heart Disease & Podiatry Sessions will take place on the 5th Floor.

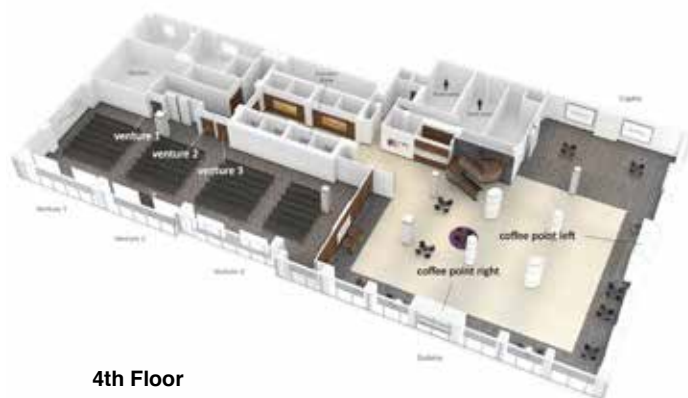

4th Floor



5th Floor

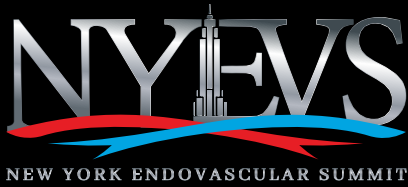

Exhibit Prospectus

EQUIPMENT & STAFFING

Exhibits will be located on the 4th Floor of etc.venues. Please provide us with the names of the individuals who will be representing your company by completing and returning the Sponsorship Agreement and Badge Form, which is located on pages 7 & 8 of this Prospectus.

Each 6' Table Top Exhibit will be entitled to 3 Complimentary Full-Meeting Badges, 10' x 10' Exhibit; 6 Badges and 10' x 20' Exhibit; 10 Badges. Additional badges are \$150.00 each. Each badge gives exhibitor full meeting access.

The following will be provided for your use at no additional charge:

- 1 Skirted exhibit table measuring 6'x30"
- 2 Side Chairs
- 1 Wastebasket Each 10'

EXPO SERVICE

Expo Services will be provided by LES Expo Services. Please see the symposium website for the LES Service Kit or contact Jeff Shutts at Jeff.Shutts@willwork.com

ELECTRICITY

A 20-Amp electrical outlet will be included with your booth fee. If you require additional electricity, additional fees may be charged. Please let us know in advance of any additional electricity you will require so we can obtain a quote for you.

SET-UP AND DISMANTLING OF EXHIBITS

Exhibit set-up starts on Wednesday, October 5th between 2:00 pm and 5:00 pm. Exhibits must be set by 5:00 pm on Wednesday, October 5th. Set-up of exhibits will not be allowed while attendees are present. Dismantling of exhibits will take place on Saturday, October 8th after the lunch break.

EXHIBIT HOURS

Wednesday, October 5th	2:00 p.m. – 5:00 p.m.	Exhibit Set-Up
Thursday, October 6th	7:00 a.m. – 6:15 p.m.	Exhibits Open Endovascular Fellows Course
Friday, October 7th	7:15 a.m. – 5:15 p.m.	Exhibits Open NYEVS Symposium
Saturday, October 8th	7:15 a.m. – 1:00 p.m. 1:00 p.m. – 4:00 p.m.	Exhibits Open NYEVS Symposium Exhibit Dismantle

EXPO SERVICE/SHIPPING OF MATERIALS

LES Expo Service/Jeff Shutts is the preferred provider for all Exhibit Materials. Please note, it is **STRONGLY** encouraged that you ship your exhibit materials **Advance to Warehouse**. Your exhibit will be stored and brought to etc.venues at no additional charge to your organization, and will then be returned to the warehouse for return shipping to your organization. Your materials will be covered under the LES Expo COI form, no additional forms will be required to etc.venues. Please find shipping labels on page 9.

If you choose to ship your exhibit materials directly to etc.venues or hand carry any items to the event **your company must provide a COI to etc.venues** prior to your arrival. Please find direct to venue shipping labels on page 10. If you will be hand carrying your exhibit to etc.venues, please let us know so we can put you in contact with etc.venues to secure the correct forms.

Please contact Jeff Shutts at (407) 284-0412 or jeff.shutts@willwork.com for additional information.

Deliveries / Collections To The Venue

- Due to limited storage space, etc.venues can accept deliveries one working day prior to the start of NYEVS (Tuesday, October 4th) and store them until one working day after the NYEVS event, between the hours of 8:00 a.m. - 5:00 p.m. (Monday to Friday only)
- All items must be labelled clearly using the labels in this document for them to be accepted
- Any items left at the venue outside of these times may be disposed of at the charge of \$500+VAT per item.

Couriers

- At the end of the NYEVS event, if you are leaving any materials to be collected by a courier, please ensure they are labelled correctly (name of person, company, address and number of items) and confirm this with the event manager prior to departure

If you need to ship displays, literature or other materials directly to etc.venues, Labels **MUST** read the same as the labels provided on the last page of this prospectus.

IMPORTANT SHIPPING DETAILS

If shipping direct to the venue, YOU MUST notify the program organizers at jennifer@gaffneyevents.com and jeff.shutts@willwork.com exactly what you are shipping, how many boxes, and box dimensions so that we may inform the venue of what will be arriving.

SHIPMENT CONFIRMATION

GAFFNEY EVENTS will not assume responsibility for the confirmation of shipped materials or equipment. The exhibitor is solely responsible for their property including loss, damage, or failure to arrive in a timely manner from the initial shipment, up to and including the final shipment to the final destination.

LIABILITY

GAFFNEY EVENTS is not responsible, and the "Exhibitor" hereby waives all claims against the aforementioned, for loss, damage, destruction of property, or bodily injury occurring at or in connection with the exhibit or conference. Further, the exhibitor agrees to hold harmless **GAFFNEY EVENTS** and its employees and agents with respect to such claims and indemnify them against such claims brought by third parties arising out of the actions of exhibitor or its employees. Each exhibitor is responsible for obtaining its own insurance for bodily injury or property loss or damage occurring in connection with the exhibit.

ADDITIONAL INFORMATION

If you have any questions or concerns regarding exhibiting at the 2022 Mount Sinai Endovascular Fellows Course & NYEVS Symposium, please feel free to contact Jennifer Berens at jennifer@gaffneyevents.com or 425.442.1314.

We look forward to seeing you in New York in October!



EXHIBITS

Exhibit Booth Fee includes participation at both the **Mount Sinai Endovascular Fellows Course & NY Endovascular Summit**.

All exhibitors are invited to participate in the Fellows Hands-On Simulator Training Sessions on Thursday, October 6th.

- \$10,000** **6' Table Top Exhibit** (Includes 3 Complimentary Full-Meeting Badges)
- \$15,000** **10' x 10' Exhibit** (Includes 6 Complimentary Full-Meeting Badges)
- \$25,000** **10' x 20' Premium Exhibit** (Includes 10 Complimentary Full-Meeting Badges)

SPONSORSHIPS & BRANDING OPPORTUNITIES

- \$25,000 Endovascular Fellows Course Lunch Symposium**
 - Exclusive Opportunity to showcase your company products or message to attendees of the Thursday Endovascular Fellows Course.
 - Includes Room Rental & Audio-Visual Equipment, Food and Beverages
 - Includes Recognition Signage
 - 1 Available
- \$25,000 Endovascular Fellows Course Breakout Session Sponsorship**
 - Showcase your product during the dedicated Fellows Hands-On Rotation Session
 - Includes Meeting Room Space, A/V (if needed)
 - 1 Available
- \$25,000 Staircase Wraps**
 - Showcase your brand on the highly visible staircase wraps at etc.venues. Glass panels available on both 4th and 5th floor.
 - Vendor to supply artwork
 - 2 Available
- \$25,000 Symposium Wi-Fi**
 - Attendees will stay connected with WiFi compliments of your company. Company recognition and custom password of your choice
 - 1 Available
- \$20,000 Coffee Station Branding**
 - Graphics of your choice to be placed on 2 locations of the coffee & beverage stations visible throughout meeting space. Vendor to supply artwork.
 - 4 Available (2 located on 4th Floor, 2 located on 5th Floor). Location given on first-come, first-served basis



Staircase Example



Staircase Example 2



Coffee Station Example

☐ **\$20,000 LightBox Graphic**

Showcase your brand or product to attendees right when they walk off the elevator, with these highly visible backlit graphics located directly at the elevator doors.

- 3 Available

☐ **\$20,000 Lanyards**

Highlight your company logo or brand along with NYEVS on custom program lanyards given to all symposium attendees

- 1 Available

☐ **\$15,000 Column Wraps | 4th and 5th Floors**

Graphic of your choice to be placed on columns throughout the 4th and 5th floors of etc.venues. Vendor to supply artwork

- 8 Available

☐ **\$15,000 Faculty Lounge**

Company Logo screensavers placed on all computers in NYEVS Faculty Lounge

- Includes Recognition Signage
- 1 Available

☐ **\$15,000 Marketing Advertisement in Mount Sinai NYEVS Eblast**

- Company Advertisement in 1 Mount Sinai Endovascular Fellows or NYEVS Promotional Eblast
- 4 Available (2 Pre and 2 Post Conference eblasts available)

☐ **\$10,000 Elevator Cling**

Graphic of your choice to be placed on elevator door on 4th and 5th floors of etc.venues

- 6 Available



Coffee Station Example 2



Light Box Graphic Example



5th Floor Column Example



etc.venues conference room



4th Floor Column Example

SPONSORSHIP FORM

2022 MOUNT SINAI ENDOVASCULAR FELLOWS & NY ENDOVASCULAR SUMMIT
etc.venues • October 6 - 8, 2022

Company Name (As it should appear on printed material)		
Contact Person (Individual to whom all exhibitor information will be forwarded)	Title	
Street Address		
City	State	Zip
Telephone	Fax	Email

PARTNERSHIP LEVELS

- \$10,000** **6' Table Top Exhibit** *(Includes 3 Complimentary Full-Meeting Badges)*
- \$15,000** **10' x 10' Exhibit** *(Includes 6 Complimentary Full-Meeting Badges)*
- \$25,000** **10' x 20' Premium Exhibit** *(Includes 10 Complimentary Full-Meeting Badges)*

SPONSORSHIPS & BRANDING OPPORTUNITIES (Please select all that apply)

<ul style="list-style-type: none"> <input type="checkbox"/> \$25,000 Endovascular Fellows Course Lunch Symposium • 1 Available <input type="checkbox"/> \$25,000 Endovascular Fellows Course Breakout Session Sponsorship • 1 Available <input type="checkbox"/> \$25,000 Staircase Wraps • 2 Available <input type="checkbox"/> \$25,000 Symposium Wi-Fi • 1 Available <input type="checkbox"/> \$20,000 Coffee Station Branding • 4 Available <input type="checkbox"/> \$20,000 LightBox Graphic • 3 Available 	<ul style="list-style-type: none"> <input type="checkbox"/> \$20,000 Lanyards • 1 Available <input type="checkbox"/> \$15,000 Column Wraps 4th & 5th Floors • 8 Available <input type="checkbox"/> \$15,000 Faculty Lounge • 1 Available <input type="checkbox"/> \$15,000 Marketing Advertisement in Mount Sinai NYEVS Eblast • 4 Available <input type="checkbox"/> \$10,000 Elevator Cling • 6 Available
--	---

PAYMENT

Make checks payable to: Gaffney Events Educational Trust Mail: Gaffney Events, 27322 NE 143rd Place, Duvall, WA 98019 <i>There will be a 3% service charge added to all credit card transactions</i>	EIN #: 47-3109028 Phone: (425) 442-1314 Email: jennifer@gaffneyevents.com
Pay by credit card: CC# _____ Exp. _____ CCV _____	

By signing below I acknowledge that I have fully read and understood the etc.venue's shipping and handling instructions. I understand that if I have any questions or concerns about this policy, it is my responsibility to discuss this with the venue.

Signature _____

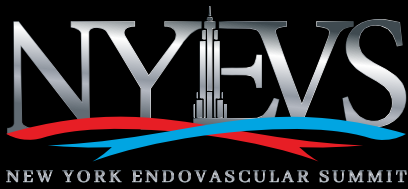

Badge Form

Please provide us with the names of the individuals who will be representing your company by completing and returning this form prior to **Friday, September 23rd**. Please return this form to Jennifer Berens at Gaffney Events via email at jennifer@gaffneyevents.com.

COMPANY NAME: _____

STAFFING

Inline Exhibit = 3 Badges Corner Exhibit = 6 Badges Large Premium Exhibit = 10 Badges

NAME (as it should appear on badge)	EMAIL ADDRESS
1	
2	
3	
4	
5	
6	
7	
8	
9	
10	

**Additional Badges - \$150.00 each*

Please Make Checks Payable To:

Gaffney Events Educational Trust
C/O NYEVS 2022
27322 NE 143rd Place
Duvall, WA 98019
Tax ID#: 47-3109028

Mail Badge Form and Check To:

Attn: Gaffney Events
27322 NE 143rd Place
Duvall, WA 98019
PH: 206.310.3612



PAYMENT VIA CREDIT CARD

Visa MasterCard American Express Discover *(There will be a 3% service charge added to all credit card transactions)*

NAME AS IT APPEARS ON CARD: _____

CREDIT CARD NUMBER: _____ CVV: _____

ADDRESS: _____ EXP. DATE: _____

SIGNATURE: _____

AUTHORIZED COMPANY REPRESENTATIVE: _____

SIGNATURE: _____ DATE: _____

October 6-8, 2022 • etc.venues • New York, New York

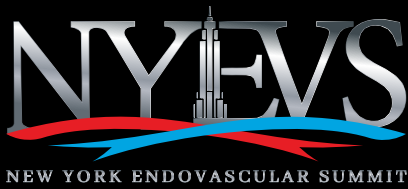

Advance to Warehouse Shipping Labels

ADVANCE TO WAREHOUSE

From:

To:

Exhibiting Company

Mount Sinai - NYEVS

Name of the Event

Gaffney Events

C/O DEMERS

151a Park Ave.

East Hartford, CT 06108

Package _____ of _____

MUST BE RECEIVED BY:
Friday, September 30th by 3:30 pm

ADVANCE TO WAREHOUSE

From:

To:

Exhibiting Company

Mount Sinai - NYEVS

Name of the Event

Gaffney Events

C/O DEMERS

151a Park Ave.

East Hartford, CT 06108

Package _____ of _____

MUST BE RECEIVED BY:
Friday, September 30th by 3:30 pm

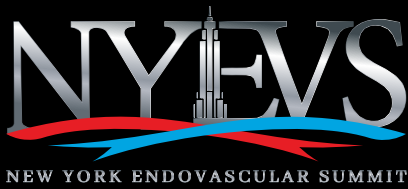

Direct to Venue Shipping Labels

DELIVERY TO VENUE

To:
etc.venues - 4th Floor
360 Madison Avenue
Located East 45 Street
New York, NY
10017

Tel:
646.844.6004
ATTN: Chelsey Dulina

FAO

Your Representative's Name: _____

Your Telephone Number: _____

Your Company Name: _____

Package _____ of _____

Name and Date of Event:

NY Endovascular Symposium – October 6-8, 2022

DELIVERY TO VENUE

To:
etc.venues - 4th Floor
360 Madison Avenue
Located East 45 Street
New York, NY
10017

Tel:
646.844.6004
ATTN: Chelsey Dulina

FAO

Your Representative's Name: _____

Your Telephone Number: _____

Your Company Name: _____

Package _____ of _____

Name and Date of Event:

NY Endovascular Symposium – October 6-8, 2022